



## ASSEMBLY AND INSTALLATION INSTRUCTIONS

### STEP 1: REVIEW & CHECK

#### A) CONFIRM DOOR HEIGHT & WIDTH

You have purchased a DOUBLE Retractable Screen for an OUTSWING door.

**HEIGHT:** This unit is available in two sizes: Retro and Full-Size. Please make sure that the screen unit you have purchased matches your door height.

**WIDTH: Retro:** If this screen unit is RETRO SIZE, it will fit door widths of 6/0 (without cutting) and 5/10, 5/4 or 5/0 (with cutting). **Full-Size:** If this screen unit is FULL-SIZE, it will fit door widths of 6/0 (without cutting) and 5/4 or 5/0 (with cutting). Please make sure that your door width is 6/0, 5/10, 5/4 or 5/0 (Retro) or 6/0, 5/4/ or 5/0 (Full-Size).

More detailed information about door height and width may be found here: <http://simplyelegantproducts.com/door-dims>

#### B) PART REVIEW

Verify that the following components are included in the box. Parts are listed from left to right. **See Figure 1A >**

1. Screen Housing marked A and D (one)
2. Screen Housing marked B and C (one)
3. Header (Top) Screen Track, marked A and B (one)
4. Sill (Bottom) Screen Track, marked C and D (one)
5. Header and Sill Screen Track Covers (two)
6. Mounting Screws for corner and tracks
  - a. Four - #8 x 2-1/2" phillips head tapping screws
  - b. Ten - #8 x 1-1/2" phillips head tapping screws
  - c. Four - #8 x 1/2" phillips head tapping screws
7. Screen Housing Circular Screw Covers (four)

#### C) TOOLS REQUIRED **See Figure 1B >**

- Level
- Square
- Tape Measure
- Drill
- Screwdriver: flat head and Phillips head
- Pencil
- Hacksaw

FIG. 1A

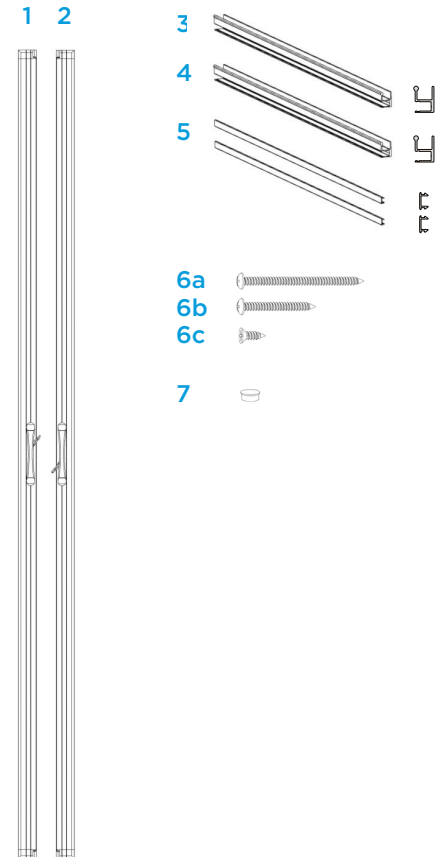
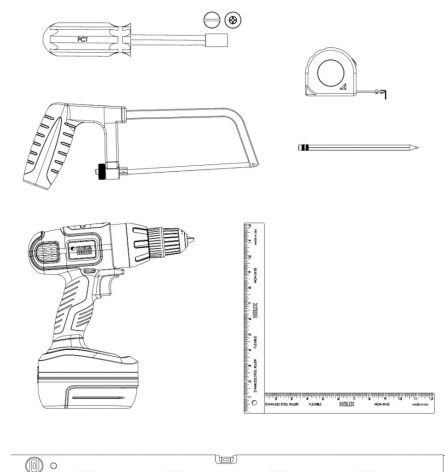

FIG. 1B





## ASSEMBLY AND INSTALLATION INSTRUCTIONS

### STEP 2: ASSEMBLY PREPARATIONS

Very important! Please examine the picture at right for additional details. **See Figure 2A >**

Before proceeding to assembly, please look at the back of the header and sill screen tracks (**Items 3 & 4**). There you will find the numbers 6/0, 5/10, 5/4 and 5/0 printed on each end of both tracks. These numbers correspond to the door unit size that the screen will fit onto.

Depending on the size of the door unit on which this system is being installed, you may need to cut BOTH ENDS on the line that corresponds with your door unit size. NOTE: the 6/0 size DOES NOT require cutting.

#### IF YOU HAVE A 5/10, 5/4 OR 5/0 DOOR

For 5/10 (Retro only), 5/4 or 5/0 doors, you will need to cut the header and sill screen tracks (**Items 3 & 4**) AND the header and sill screen track covers (**Item 5**) on both ends.

Using a hacksaw, saw the header screen track (**Item 3**) on the line - 5/10 (Retro only), 5/4 or 5/0 - that corresponds to your door size. NOTE: the track must be cut on both sides. Repeat for the sill screen track (**Item 4**). **See Figure 2B >**

Now, saw the header and sill screen track covers (**Item 5**) to match. NOTE: the header and sill screen track covers do not have clear tape with 5/10, 5/4 or 5/0 markings. You will need to cut the header and sill screen track covers to match the NEW width of the header and sill screen tracks (**Items 3 & 4**).

FIG. 2A

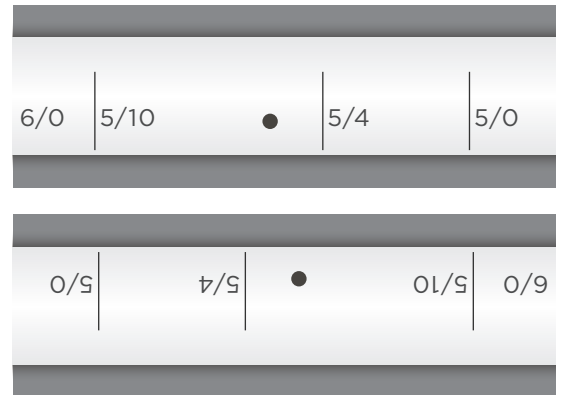
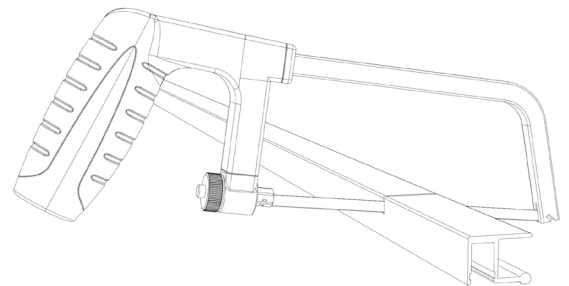

FIG. 2B





## ASSEMBLY AND INSTALLATION INSTRUCTIONS

### STEP 3: ASSEMBLY

Place all the items from the box on the floor in front of the patio or single door where the single screen is to be installed.

The screen housings (**Items 1 & 2**) and header and sill screen tracks (**Items 3 & 4**) should line up with their corresponding letters in a clockwise fashion, as shown at right: A to A, B to B, C to C, D to D. **See Figure 3A >**

FIG. 3A

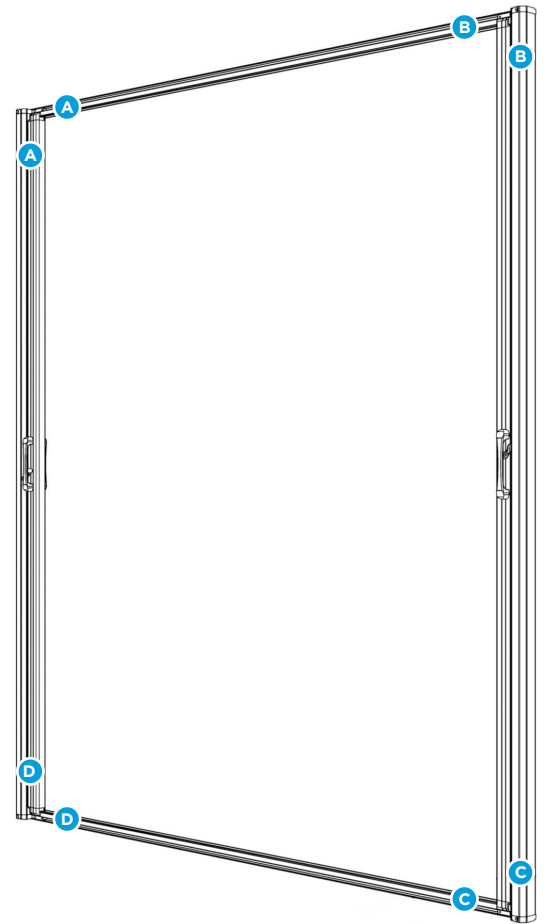

Slide the header (top) and sill (bottom) screen tracks onto the slide guides of both screen housings (**Items 1 & 2**). It is very important that these lock in place correctly. **See Figure 3B >**

Lock in clockwise fashion as indicated below: A to A, B to B, C to C and D to D. The screen frame unit is now prepped and ready for locking the assembly together.

FIG. 3B

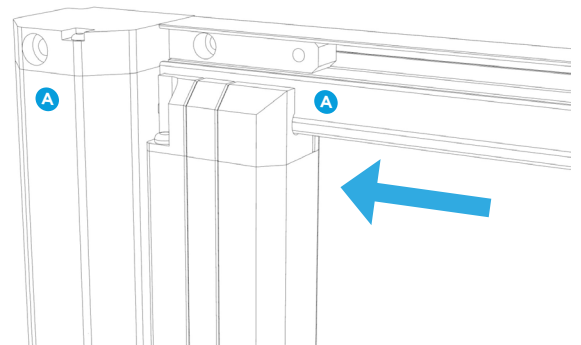



## ASSEMBLY AND INSTALLATION INSTRUCTIONS

### STEP 3: ASSEMBLY *(continued)*

#### FLIP AND TIGHTEN

We now need to tighten the assembled screen unit. Flip the screen unit up and away from the door where the screen will be installed so that you now see the back side of the screen unit.

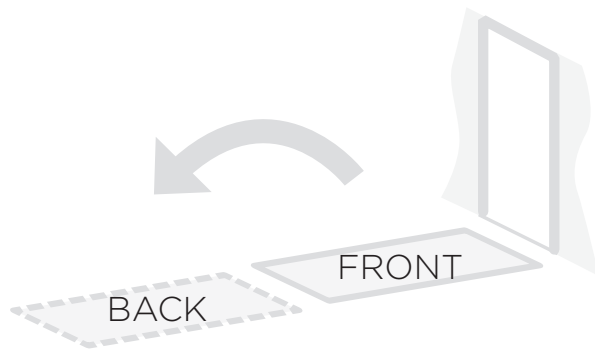

Using the #8 x 1/2" phillips head tapping screws (**Item 6c**), lock both screen housings (**Items 1 & 2**) to both the header (top) and sill (bottom) screen tracks (**Items 3 & 4**) by tightening. Repeat for all four corners. **See Figure 3C >**

Now, flip screen door unit back over so that you see the front side of the retractable screen.

FIG. 3C

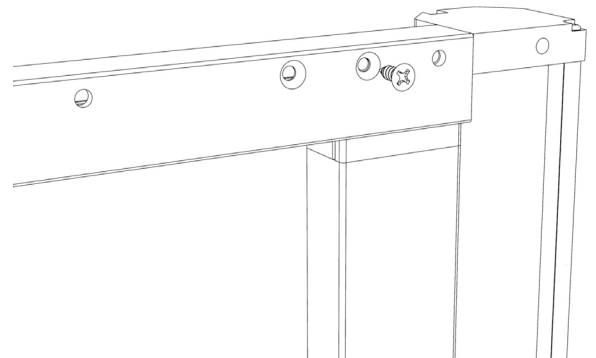
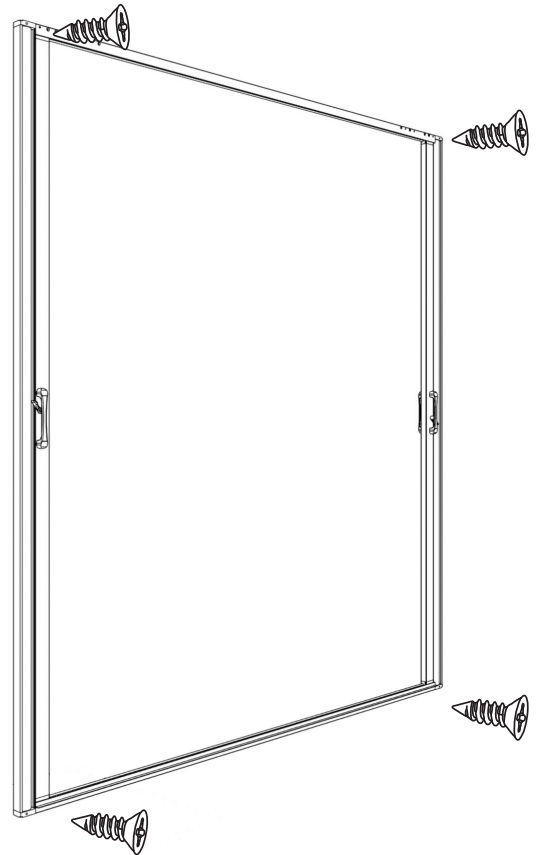



## ASSEMBLY AND INSTALLATION INSTRUCTIONS

### STEP 4: INSTALLATION

#### REMOVE MOLDING

Remove all trim molding, if present, from the interior side of both the door frame and the door sill before installing the double retractable screen. This will provide a uniform surface around the frame of the door for installation. **See Figure 4A >**

#### POSITION SCREEN

Now move the assembled screen unit up and center it on the door unit. The sill screen track (**Item 4**) should be positioned at least 1/8" below the top of the door sill. **See Figure 4B >**

FIG. 4A

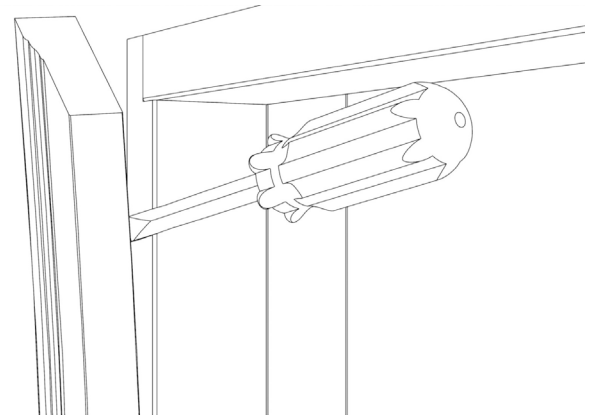

Remove trim molding  
around frame and sill

FIG. 4B

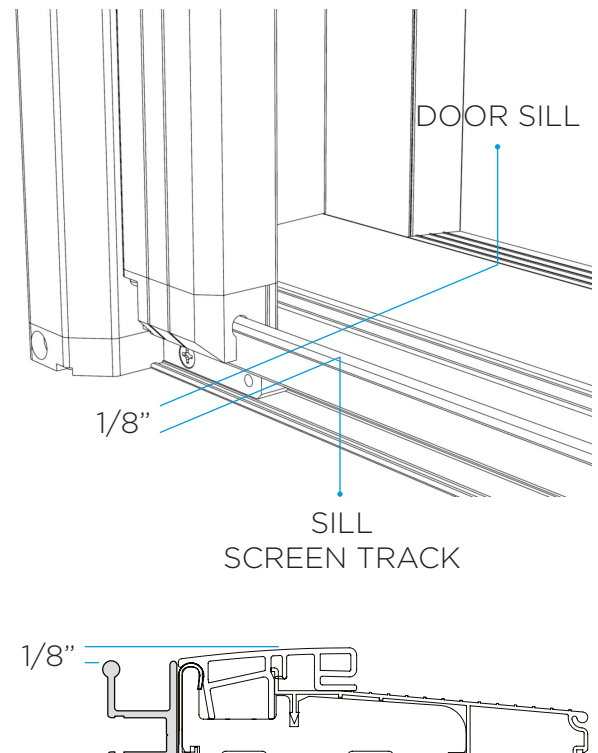



## ASSEMBLY AND INSTALLATION INSTRUCTIONS

### STEP 4: INSTALLATION *(continued)*

#### MOUNT HEAD TRACK TO DOOR FRAME

After positioning the screen frame on the door opening and making sure the two screens meet up in the center correctly with the door, screw the header screen track into the door frame using two #8 x 1-1/2" screws (**Item 6b**). See **Figure 4C** >

Screw in ONLY TWO of the four #8 X 1-1/2" (**Item 6b**) screws because you may need to adjust the position of the screen unit to make sure that the screen is square and level. See **Figure 4D** >

#### MOUNT SILL TRACK TO DOOR SILL

Check again to make sure the sill screen track is below the door sill by at least 1/8". See **Figure 4B**

Once this is done, check again to make sure the screen is square and level. Also, test that the retractable screens open and close smoothly and easily without twisting. If it is not square and level or does not operate smoothly, adjust.

Now screw the sill screen track (**Item 4**) to the door sill and the screen housings (**Items 1 & 2**) to the door jamb. See **Figure 4E** >

FIG. 4C

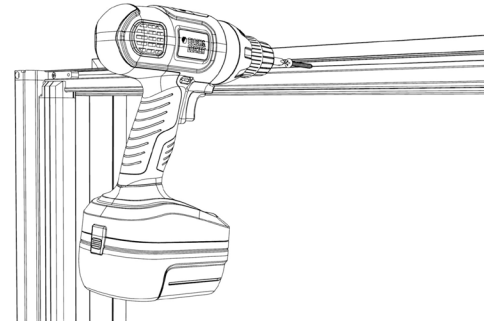

FIG. 4D

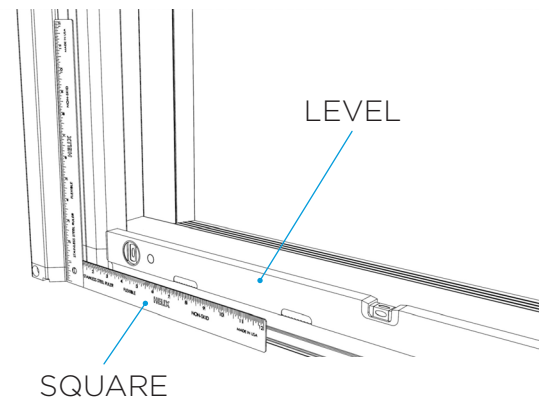
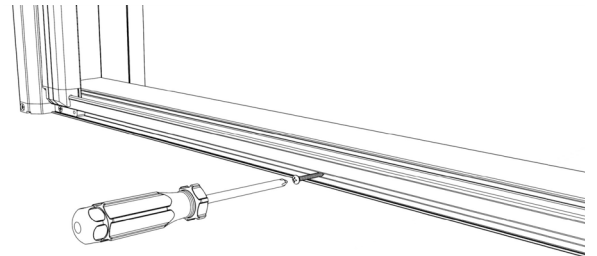

FIG. 4E





## ASSEMBLY AND INSTALLATION INSTRUCTIONS

### STEP 4: INSTALLATION *(continued)*

#### INSERT REMAINING SCREWS

Add the rest of the #8 x 1-1/2" screws **(Item 6b)** to the header screen track and tighten. Finish by screwing the screen housing at each corner with #8 x 2-1/2" screws **(Item 6a)**. All screws should be securely fastened at this stage. **See Figure 4F >**

#### SNAP IN SCREEN TRACK & SCREW COVERS

Now snap in the header and sill screen track covers **(Item 5)** to the front sides of both the header and sill screen tracks **(Items 3 & 4)**. **See Figure 4G >**

Once complete, pop in the small screen housing circular screw covers **(Item 7)** to cover each hole. **See Figure 4H >**

**YOUR RETRACTABLE SCREEN  
INSTALLATION IS NOW COMPLETE!**

### MAINTENANCE

For continued high performance, check from time to time to make sure the bottom track is clear of debris. In addition, occasionally apply a dry silicone spray to the top and bottom tracks to ensure smooth screen operation.

FIG. 4F

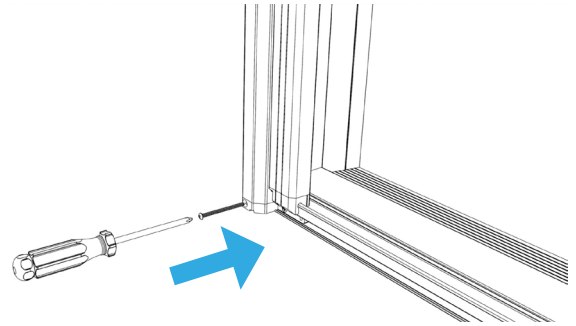

FIG. 4G

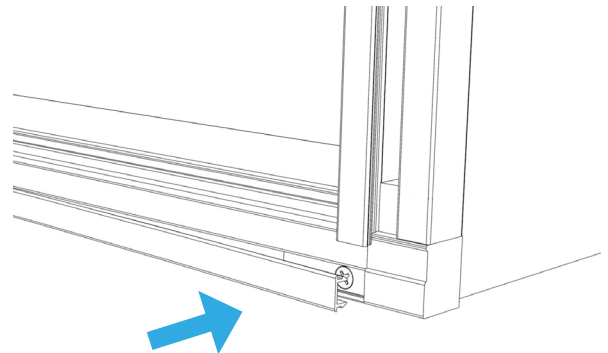

FIG. 4H

