



## ASSEMBLY AND INSTALLATION INSTRUCTIONS

### STEP 1: REVIEW & CHECK

#### A) CONFIRM DOOR HEIGHT & WIDTH

You have purchased a DOUBLE Retractable Screen for an INSWING door.

**HEIGHT:** This unit is available in two sizes: Retro and Full-Size. Please make sure that the screen unit you have purchased matches your door height.

**WIDTH:** This screen unit will fit door widths of 6/0 (without cutting) and 5/10 (Retro Only), 5/4 or 5/0 (with cutting).

If you need additional information on measurements, download sizing document here: <http://bit.ly/SEsizing>.

#### B) PART REVIEW

Verify that the following components are included in the box. Parts are listed from left to right. **See Figure 1A >**

1. Screen Housing marked A and D (1)
2. Screen Housing marked B and C (1)
3. Header (top) Screen Track with locking hardware marked A and B (1)
4. Sill (bottom) Screen Track with locking hardware marked C and D (1)
5. Screen Track Covers (2)
6. Mounting Screws for corner and tracks
  - a. Four - #8 x 3" phillips head tapping screws
  - b. Five - #8 x 1-1/2" phillips head tapping screws
  - c. Four - #8 x 5/8" phillips head tapping screws
  - d. Five - #8 x 1/2" phillips head self-drilling screws
  - e. Four - #8 x 1" self-drilling screws
7. Screen Housing Circular Screw Covers (4)

#### C) TOOLS REQUIRED **See Figure 1B >**

- Level
- Square
- Tape Measure
- Drill
- Rubber Mallet
- Screwdriver: flat head and Phillips head
- Pencil
- Hacksaw

FIG. 1A

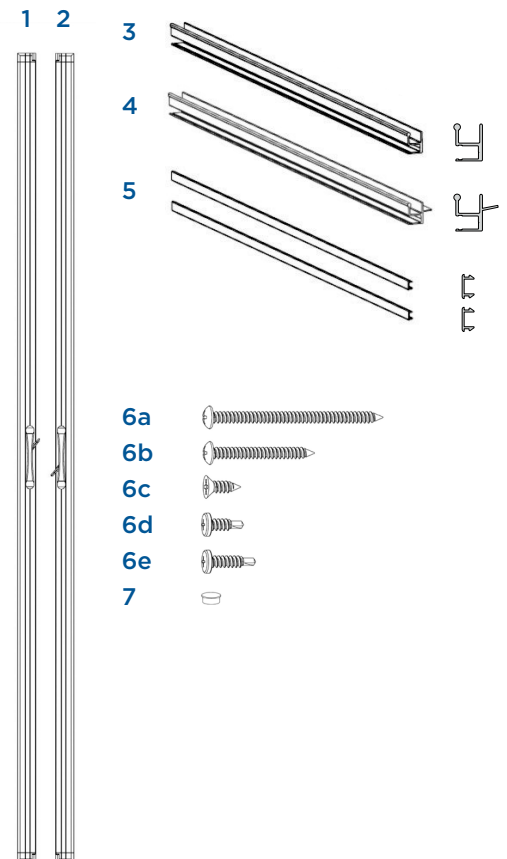
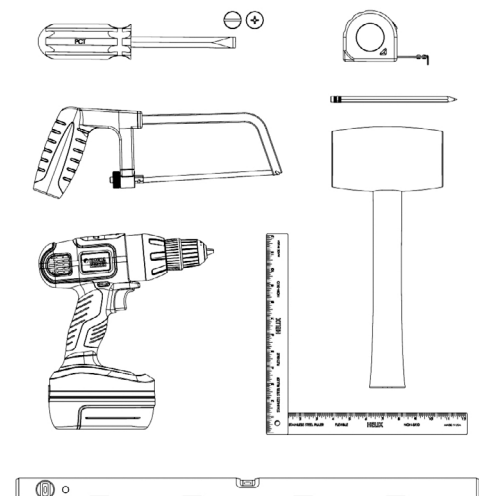

FIG. 1B





## ASSEMBLY AND INSTALLATION INSTRUCTIONS

### STEP 2: ASSEMBLY PREPARATIONS

Very important! Please examine the picture at right for additional details. **See Figure 2A >**

Before proceeding to assembly, please look at the back of the header and sill screen tracks (Items 3 & 4). There you will find the numbers 6/0, 5/10 (Retro only), 5/4 and 5/0 printed on each end of the track. These numbers correspond to the door unit size that the screen will fit onto.

For 5/10 (Retro only), 5/4 or 5/0 doors, you will need to cut the header and sill screen tracks on both ends (Items 3 & 4). The header and sill screen track covers need to be cut on only one end (Item 5). NOTE: The 6/0 size does not require cutting.

FIG. 2A

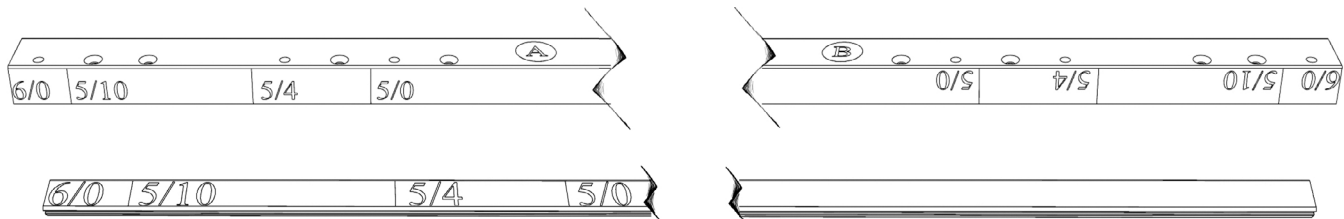

Using a hacksaw, saw the header screen track (marked A and B) on the line - 5/10 (Retro only), 5/4 or 5/0 - that corresponds to your door size. NOTE: the track must be cut on both sides. Repeat for the sill screen track (marked C and D). **See Figure 2B >**

You will now need to cut the screen track covers (Item 5) to match the NEW width of the header (Item 3) and sill screen tracks (Item 4).

FIG. 2B

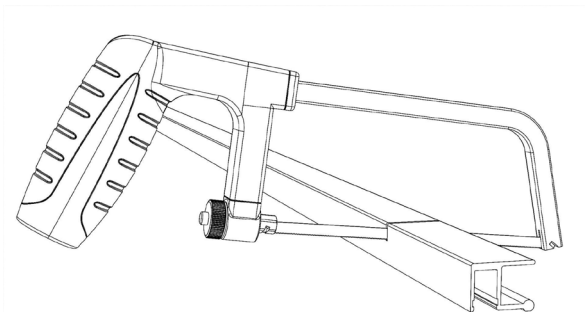



## ASSEMBLY AND INSTALLATION INSTRUCTIONS

### STEP 3: ASSEMBLY

Place all the items from the box on the floor in front of the patio or single door where the single screen is to be installed (colored stickers facing up).

The screen housings and tracks should line up with their corresponding letters in a counter-clockwise fashion, as shown at right: A to A, B to B, C to C, D to D.

Be sure to place corner D to D closest to the bottom, left corner of your door (when facing your door from outside your home).

**See Figure 3A >**

Slide each screen track onto both the handle and housing slide guides. It is very important that these lock in place correctly.

**See Figure 3B >**

Lock in counter-clockwise fashion as indicated below: A to A, B to B, C to C and D to D. The screen frame unit is now assembled and ready for locking the assembly together.

FIG. 3A

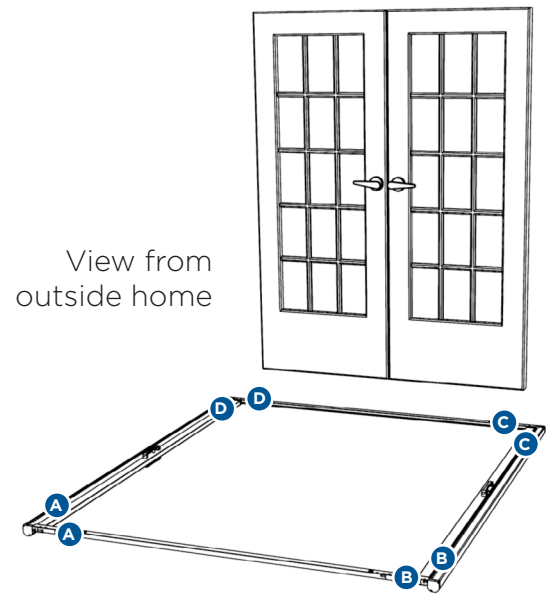
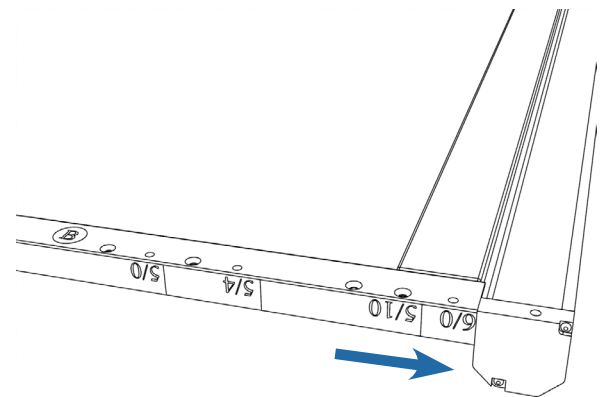

FIG. 3B





## ASSEMBLY AND INSTALLATION INSTRUCTIONS

### STEP 3: ASSEMBLY *(continued)*

#### TIGHTEN

We now need to tighten the assembled screen unit.

Using the four #8 x 5/8" phillips head tapping screws (Item 6c), lock the screen housing arm to the screen track (Items 3 & 4) by placing a screw in the second hole on the track from the end for all four corners. **See Figure 3C >**

FIG. 3C

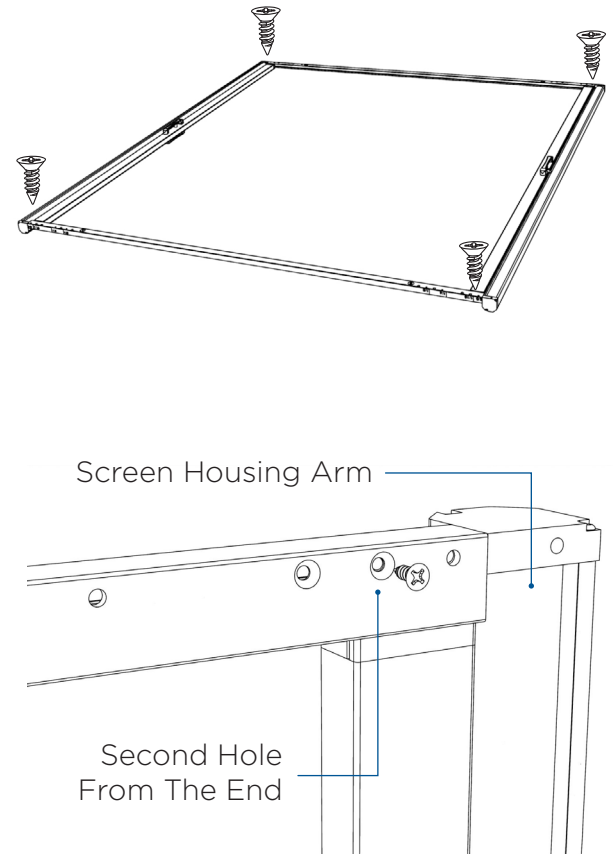



## ASSEMBLY AND INSTALLATION INSTRUCTIONS

### STEP 4: INSTALLATION

#### CONFIRM BRICKMOLD SURROUNDS DOOR

The screen unit will be mounted directly to the brickmold on the outside of the door frame. If there is no brickmold outside your door frame, you will need to purchase the Simply Elegant Molding Kit (Part #: 100-110). This will ensure that the jamb, head and sill are flush so that the screen unit will operate smoothly.

**See Figure 4A >**

#### POSITION SCREEN

Now move the assembled screen unit up and center it on the door unit. The sill track should be positioned with the flange on the back side of the sill track, resting on the outside sill edge. NOTE: The inside edge of the sill screen track will be mounted directly onto the sill. **See Figure 4B >**

Corner A-A should be at the top, left corner of your door unit (when facing your door from outside your home).

**See Figure 4C >**

FIG. 4C

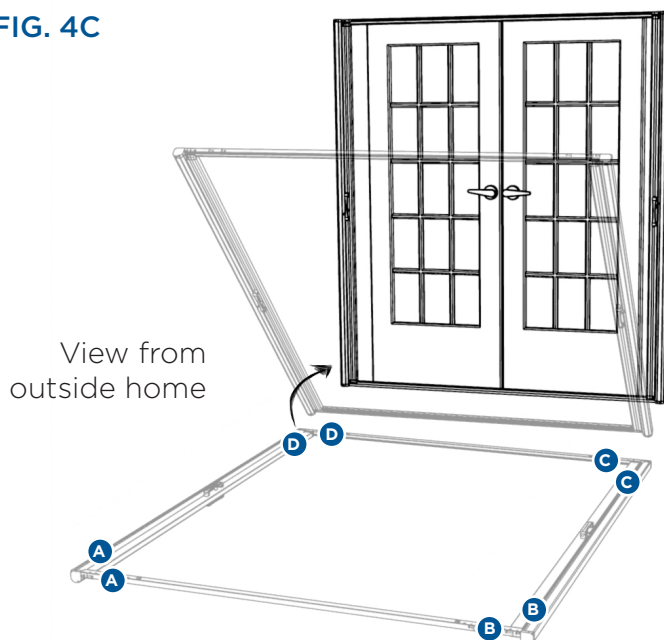

FIG. 4A

Ensure brickmold completely surrounds door

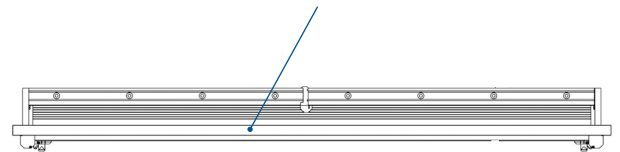

FIG. 4B

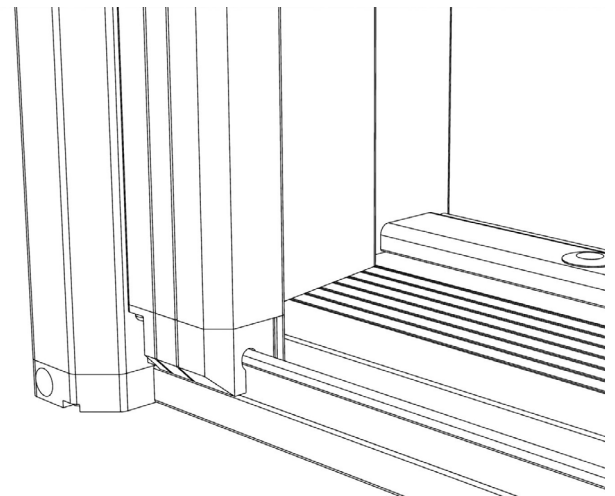
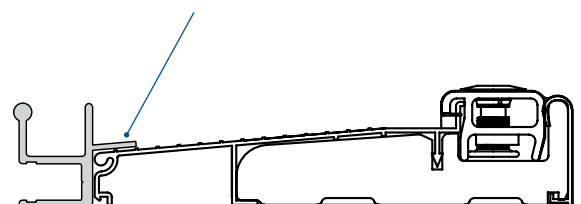

FIG. 4D

Mount sill screen track directly onto sill





## ASSEMBLY AND INSTALLATION INSTRUCTIONS

### STEP 4: INSTALLATION *(continued)*

#### MOUNT HEAD TRACK TO DOOR FRAME

Position the screen frame on the door opening and make sure the two screens meet up in the center correctly with the door.

Screw in only two of the five #8 X 1-1/2" screws (Item 6b) at the header screen track (Item 3) because you may need to adjust the position of the screen to make sure that the screen is square and level by checking all four corners and sides. **See Figures 4E and 4F >**

#### MOUNT SILL TRACK TO DOOR SILL

Once this is done, check again to make sure the screen is square and level. **See Figure 4G >** (The diagonal distance on both sides should be about the same; the difference should be no greater than 1/8".)

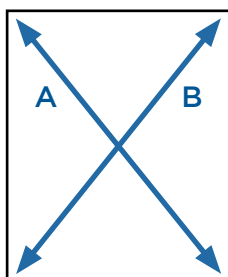

*The difference between distances A and B should be no greater than 1/8".*

Finally, test that the retractable screen opens and closes smoothly and easily without twisting. If it is not square and level or does not operate smoothly, it may need adjustments.

Once all adjustments have been made, screw the header screen track (Items 3) to the door frame using the three remaining #8 x 1-1/2" screws (Item 6b).

Next screw in five #8 x 1/2" self-drilling screws (Item 6d) along the front of the sill screen track (Item 4).

Lastly, screw four #8 x 1" self-drilling screws (Item 6e) into the sill. **See Figures 4F and 4D (page 5) >**

FIG. 4E

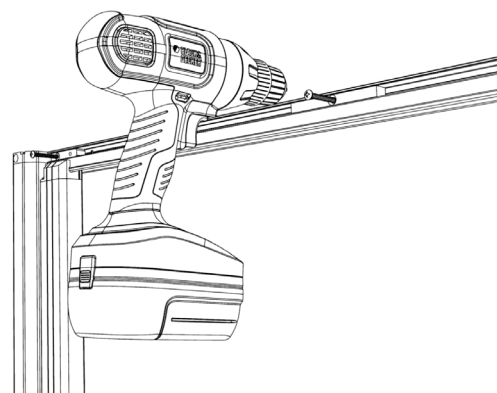

FIG. 4F

*Screw in first two screws*

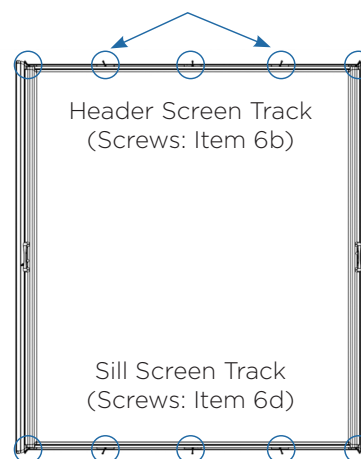
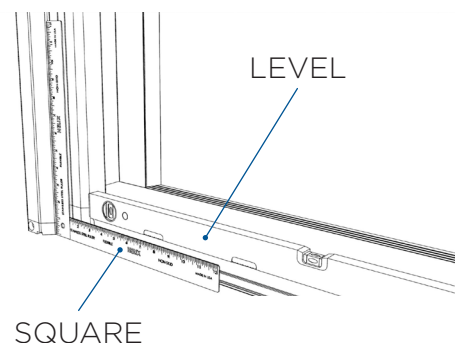

FIG. 4G





## ASSEMBLY AND INSTALLATION INSTRUCTIONS

### STEP 4: INSTALLATION *(continued)*

#### INSERT REMAINING SCREWS

Finish by screwing the screen housing at each corner with the four #8 x 3" screws (Item 6a). **See Figure 4H >** Cover these screws with four screw covers (Item 7). **See Figure 4J >**

#### SNAP IN SCREEN TRACK

Now snap in the screen track covers to the front sides of both screen tracks. Use a mallet to lightly tap these in place. **See Figure 4K >**

**YOUR RETRACTABLE SCREEN  
INSTALLATION IS NOW COMPLETE!**

### MAINTENANCE

For continued high performance, check from time to time to make sure the bottom track is clear of debris. In addition, occasionally apply a dry silicone spray to the top and bottom tracks to ensure smooth screen operation.

FIG. 4H

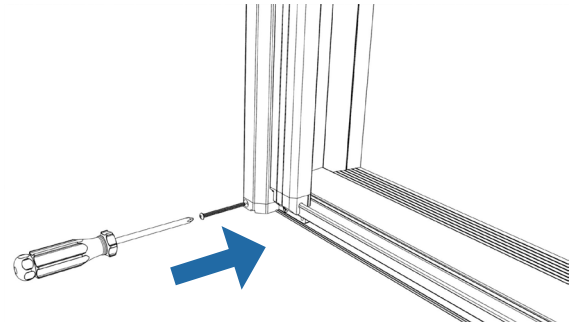

FIG. 4J

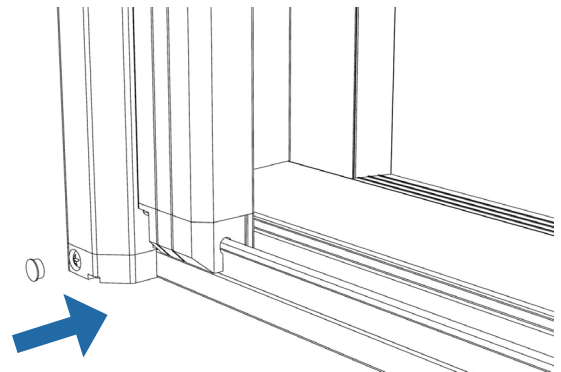

FIG. 4K

